

# GARDEN CITY SHOPPING CENTRE

8040 GARDEN CITY ROAD, RICHMOND, BC

FOR LEASE



For leasing information,  
contact:

Stephanie Setchell  
C 604-809-3096  
T 604-273-7505  
F 604-273-4696  
ssetchell@farrellestates.com

Farrell Estates Ltd.  
220 – 6911 Graybar Road  
Richmond, B.C.



LOCATION:	South east corner of Garden City Road and Blundell Road.
TRADE AREA POPULATION:	City of Richmond: 190,473 Within 3 miles: 156,335 Within 5 miles: 244,320 (2006 Census)
GLA:	130,456 square feet
PARKING:	Over 500 parking stalls
ANCHOR TENANTS:	<ul style="list-style-type: none"><li>• IGA Marketplace</li><li>• Shoppers Drug Mart</li><li>• Pet Food 'N' More</li><li>• Liquor Store</li><li>• CIBC</li></ul>
AVAILABLE PREMISES:	#450: 1,502 SF \$28.00 - \$30.00 psf

[www.farrellestates.com](http://www.farrellestates.com)

OPERATING COSTS & TAXES: Approximately \$10.00 per sq.ft.

The information set out herein (the "Information") is intended for informational purposes only. Farrell Estates Ltd. does not represent, warrant or guarantee the accuracy, correctness and completeness of the Information. Farrell Estates Ltd. does not accept or assume any responsibility or liability of any kind in connection with the Information and the recipient's reliance upon the Information. The recipient of the Information should take such steps as the recipient may deem necessary to verify the Information prior to placing any reliance upon the Information. The Information may change and any property described in the Information may be withdrawn from the market at any time without notice or obligation to the recipient from Farrell Estates Ltd.

Stephanie Setchell is licensed with Fraser River Realty Ltd. and has a contractual relationship with Farrell Estates Ltd.



# GARDEN CITY SHOPPING CENTRE

8040 GARDEN CITY ROAD, RICHMOND, BC

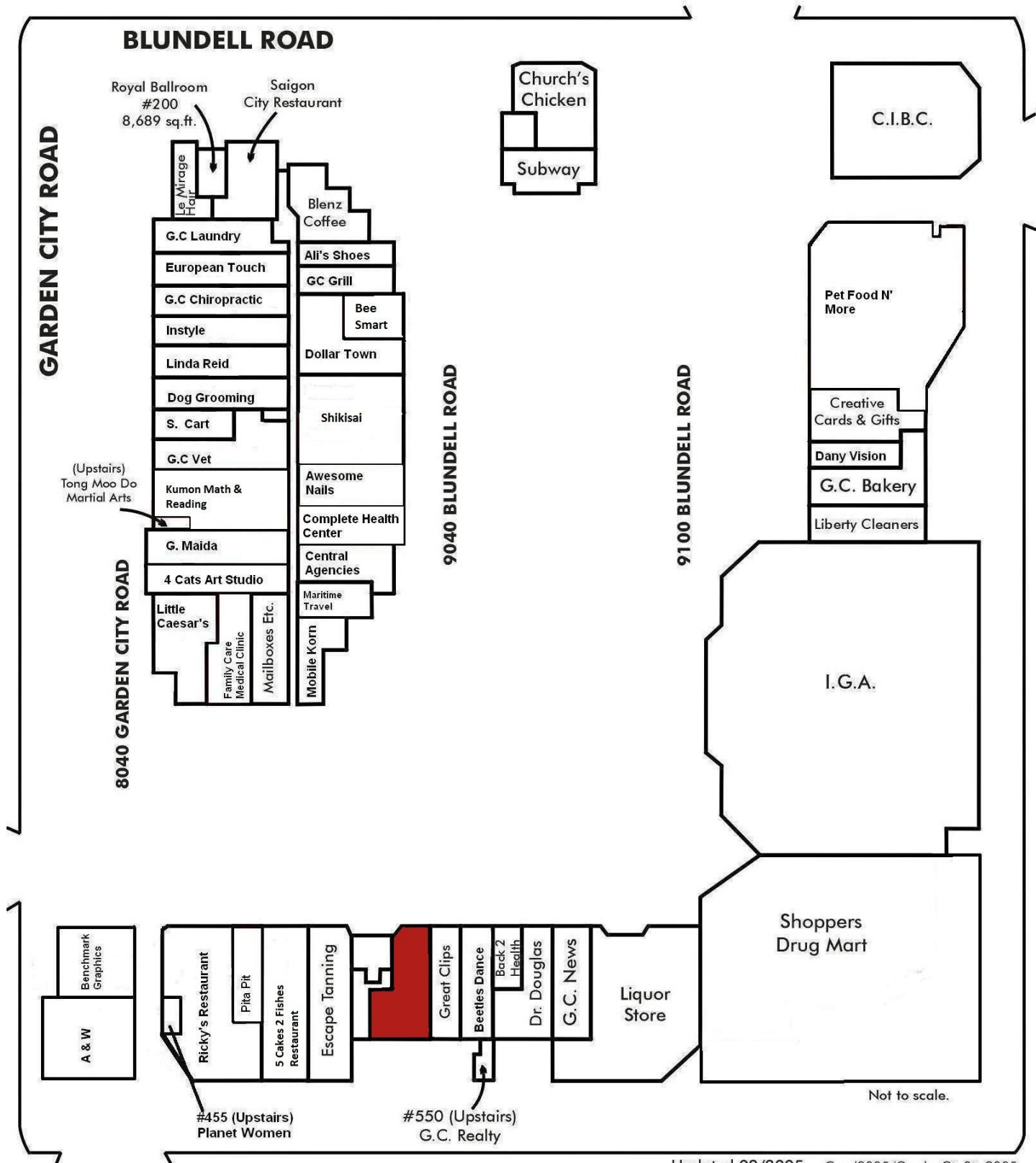

Not to scale.

Updated 08/2005 Corel2005/GardenCitySite2005

The information set out herein (the "Information") is intended for informational purposes only. Farrell Estates Ltd. does not represent, warrant or guarantee the accuracy, correctness and completeness of the Information. Farrell Estates Ltd. does not accept or assume any responsibility or liability of any kind in connection with the Information and the recipient's reliance upon the Information. The recipient of the Information should take such steps as the recipient may deem necessary to verify the Information prior to placing any reliance upon the Information. The Information may change and any property described in the Information may be withdrawn from the market at any time without notice or obligation to the recipient from Farrell Estates Ltd.



Stephanie Setchell is licensed with Fraser River Realty Ltd. and has a contractual relationship with Farrell Estates Ltd.